

INSTRUCTION FOR INSTALLATION

① Make the feet rotate 90°

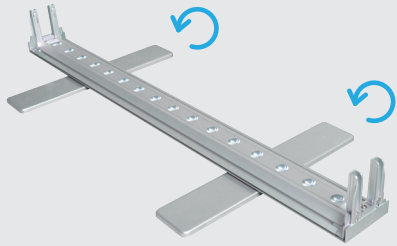

② Connect the transformer

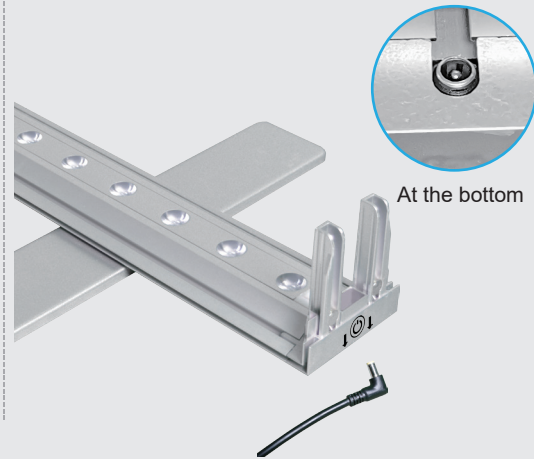

③ Match the same number together to connect correctly

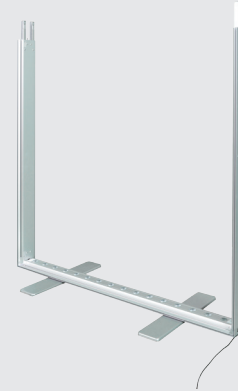

④ Match the same number together to connect correctly

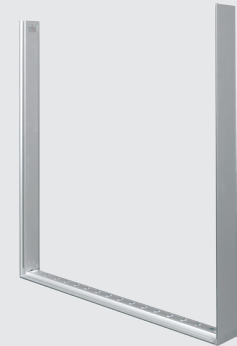

⑤ Connect the upper half and lower half

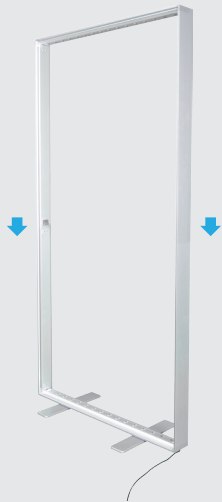

⑥ Slide the pole to fix

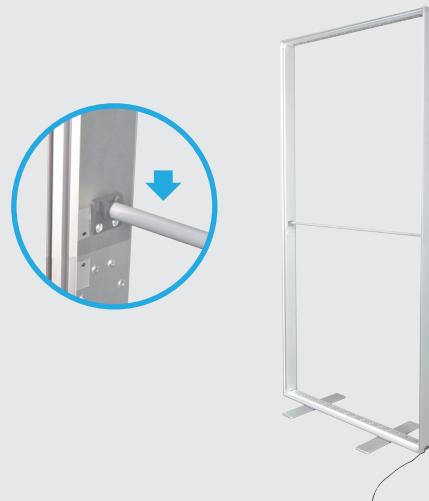

⑦ Put on graphics



⑧ Connect the power cable then connect the power



Disassemble in the reverse order.
Caution: Make sure the graphic is folded neatly and save it in bag after using, to avoid wrinkle.

PLEASE CONTACT US IF THERE IS ANY QUESTIONS.